

**Série TJN - Injectores de longo alcance - MONTAGEM**

**EXECUÇÃO BASE: TJN**

VISTA FRONTAL SEM ANEL FRONTAL

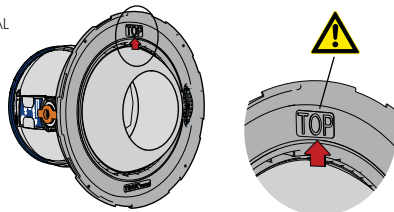

COM FORRA METÁLICA EXTERIOR (OPCIONAL)

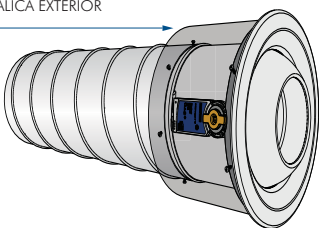

EXECUÇÃO COM ACESSÓRIO DE MONTAGEM A CONDUITA RECTANGULAR: TJN-K SEM FORRA METÁLICA EXTERIOR

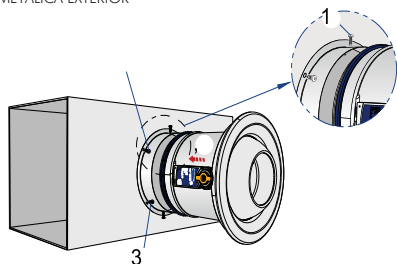

EXECUÇÃO COM ACESSÓRIO DE MONTAGEM A CONDUITA REDONDA: TJN-R SEM FORRA METÁLICA EXTERIOR

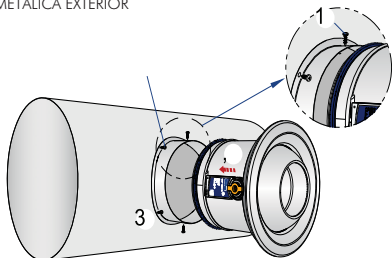

EXECUÇÃO COM FORRA METÁLICA EXTERIOR (OPCIONAL)

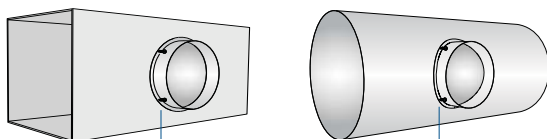

PARAFUSOS NÃO INCLUIDOS - DA RESPONSABILIDADE DO INSTALADOR

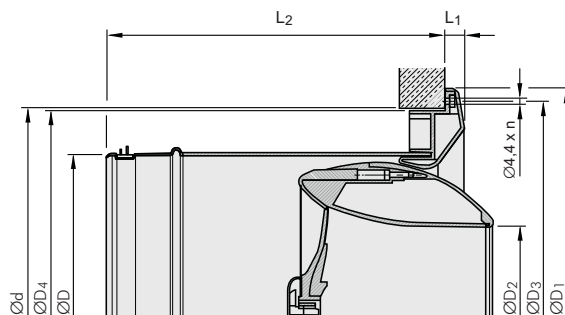
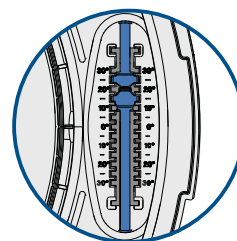
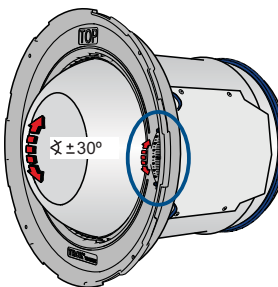
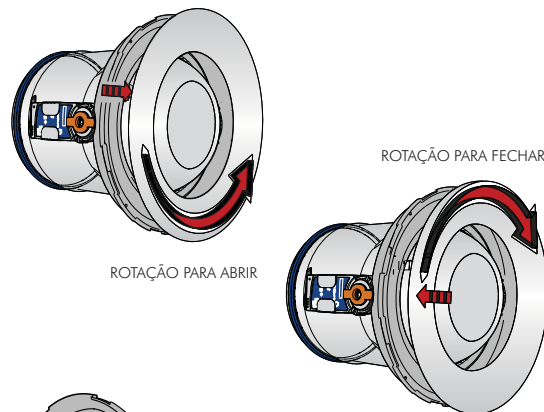
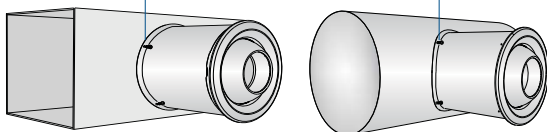

TAMANHO NOMINAL	MONTAGEM NA PAREDE								
	ØD	ØD1	ØD2	ØD3	ØD4	Ød	L1	L2	n
160	158	258	82	239	227	229	15	242	5
200	198	298	108	279	263	266	14	250	4
250	248	348	136	329	315	318	14	260	4
315	313	413	174	393	379	382	15	275	8
400	398	501	231	481	468	470	16	285	8

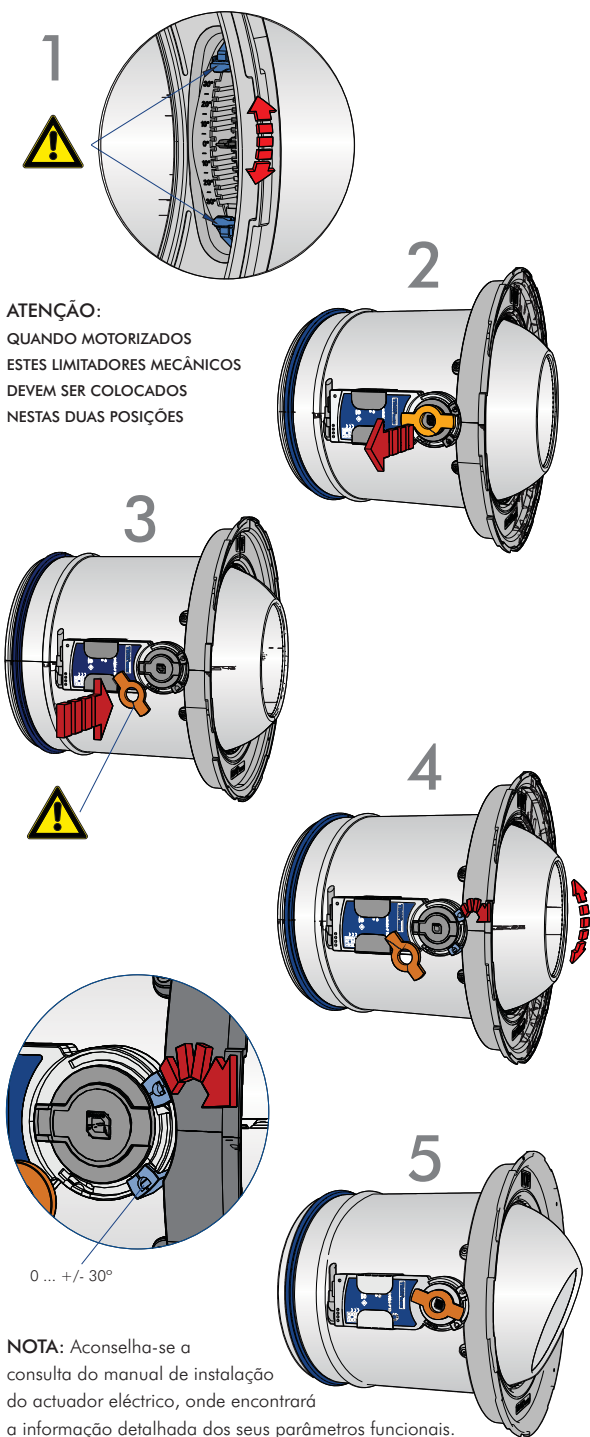

**EXECUÇÃO COM DEFLECTOR<sup>(1)</sup>  
PARA REDUÇÃO DO ALCANCE MÁXIMO**

<sup>(1)</sup>Este deflector pode ser montado em campo - fornecimento em separado

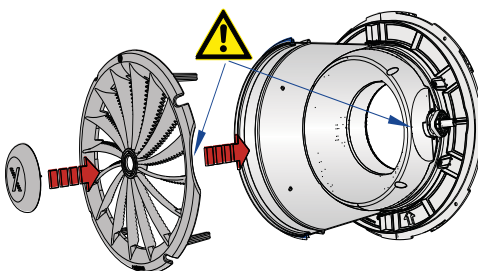

SEM DEFLECTOR

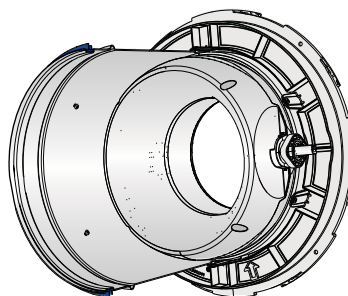

COM DEFLECTOR AJUSTADO PARA  
80% DO ALCANCE  
MÁXIMO

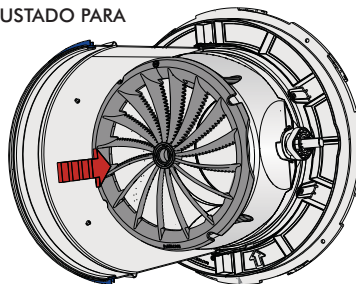

COM DEFLECTOR AJUSTADO PARA  
60% DO ALCANCE  
MÁXIMO

